

**OY HOLMIK AB**  
Maxmovägen 312  
FIN-66640 Maxmo, Finland  
Tel +358 (0)6 387 5110  
Fax +358 (0)6 345 0335  
[www.holmik.fi](http://www.holmik.fi)

© Oyj Holmik AB 2010



# Metal mesh

Expanded metal Wire cloth Perforated

**EMI/RFI-SHIELDING VOLTAGE INDICATION FILTER ELEMENTS DESIGN**

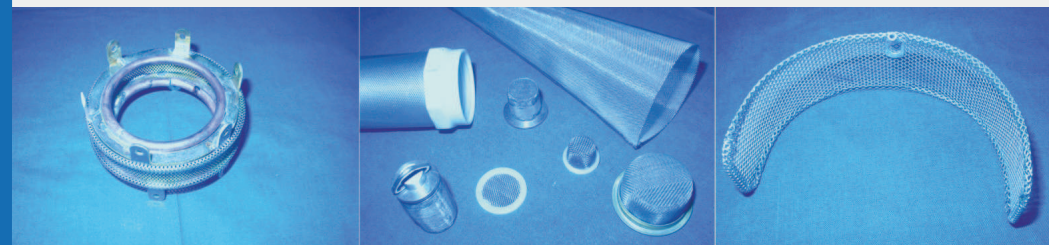

**DESIGN**

**FILTERS**

**PLASTIC**

**SHIELDING**

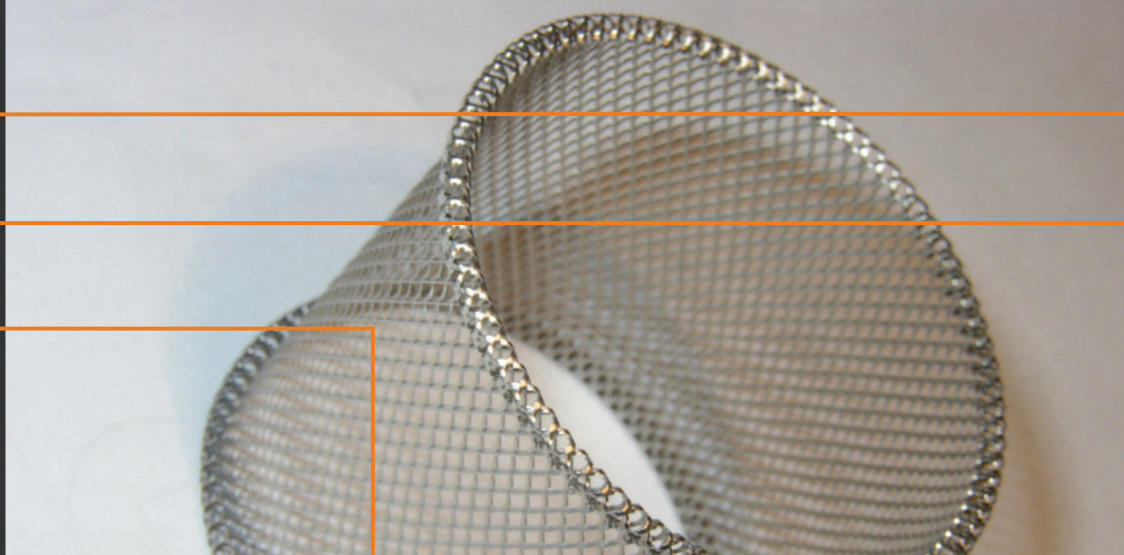

## Design and consultation

Holmik possess solid know-how of tool design and manufacture, and we are happy to share this know-how with our customers. We would like to join our customers right at the beginning of the process, in order to contribute with suggestions on how to construct and manufacture the product in a cost-efficient way, and yet achieving the right quality for the intended purpose.

We have our own design and 3D software as well as a wide network of experts and suppliers. We are happy to cater for the entire process for our customers - from construction to the finished product.

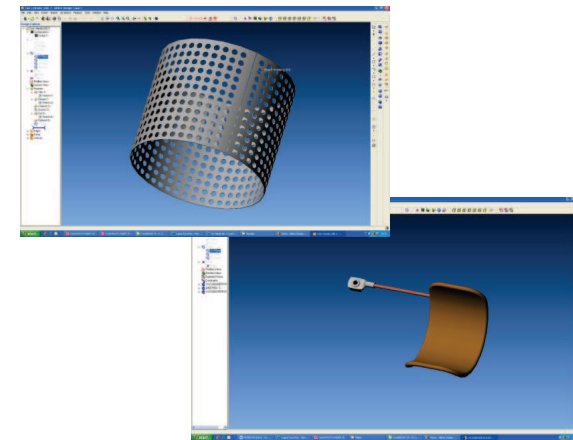

## Shielding and indication

Expanded metal, wire mesh and perforated metal provide excellent shielding against electromagnetic fields and interference. There is an additional surplus with expanded metal – it helps save material while providing a stable foundation. Many of our customers use our metal mesh products as voltage indicators and other types of sensors.

Holmik's machinery and global network guarantee complete system deliveries. We can, for instance, provide laser cutting, automatic punching, pressing, roll forming, roll welding, resistance welding, micro welding, induction brazing, automatic sandblasting, cable processing, etc.

## Combination of semi-conductive plastic

It is not possible to produce and form all the constructions out of metal mesh. Holmik can, therefore, also offer products which are a combination of plastic and metal. They are particularly suited for bigger series and in an ambition towards more cost-efficient production.

The combination of semi-conductive plastic and metal mesh is used e.g. in epoxy-moulded electric appliances. The holes in the mesh let air pass and, in this way, one can avoid air pockets in the moulding process.

## Filter cloth combined with plastic

It is also possible to combine metal mesh or filter cloth with plastic. Typical applications include different fuel filters, HVAC filters, air filters, condensate filters and medical filters.



## Metal filters, pipes and shields

Holmik produce also full-metal industrial and other filters. They are primarily used in different applications with higher durability and temperature requirements.

Furthermore, we can roll-form various tubes and cylinders in perforated metal and expanded metal in our profile line. For smaller volumes, we use circular bending machines and subsequent roll welding.

Expanded metal is well suited also for different types of air intake shields or as protective gear for machines.